



Bayliss Drive, Hednesford, Cannock, WS12 4XN

Offers Over £235,000

Hednesford

Offers Over £235,000



Welcome to Bayliss Drive, a superbly presented and meticulously finished three bedroom semi detached property that is less than 5 years old making moving in easy!

An internal inspection reveals a welcoming entrance hall, guest W/C, beautiful modern kitchen with integral appliances and finished to a high standard and completing the ground floor is spacious lounge diner perfect for entertaining guests and having French Doors into the rear garden.

Stairs lead to the first floor where the property boasts three excellent sized bedrooms, en suite to master, family bathroom and bedroom one and two with useful fitted wardrobes and storage.

Outside is a pleasant privately enclosed rear garden and to the fore is parking for multiple vehicles.

Nearby are a handful of local shops, easily accessible transport links, The McArthur Glen Shopping Complex and lastly Cannock Chase and area of outstanding natural beauty.

DO NOT MISS YOUR OPPORTUNITY TO VIEW!!!





Property Specification

BEAUTIFULLY FINISHED THREE BEDROOM SEMI
SPACIOUS LOUNGE DINER
MODERN KITCHEN WITH APPLIANCES
MASTER WITH EN SUITE AND BUILT IN WARDROBES
PRIVATELY ENCLOSED REAR GARDEN

Hallway

Guest W/C

Kitchen 12' 1" x 7' 6" (3.68m x 2.29m)

Lounge Diner 14' 11" x 14' 5" (4.55m x 4.39m)

Landing

Bedroom One 14' 5" x 8' 6" (4.39m x 2.59m)

En Suite

Bedroom Two 10' 10" x 8' 6" (3.30m x 2.59m)

Bedroom Three 8' 10" x 6' 3" (2.69m x 1.91m)

Bathroom

Viewer's Note:

Services connected: Gas, Electric, Water, Drainage
Council tax band:
Tenure: Freehold

Floor Plan

This floor plan is not drawn to scale and is for illustration purposes only

Ground Floor

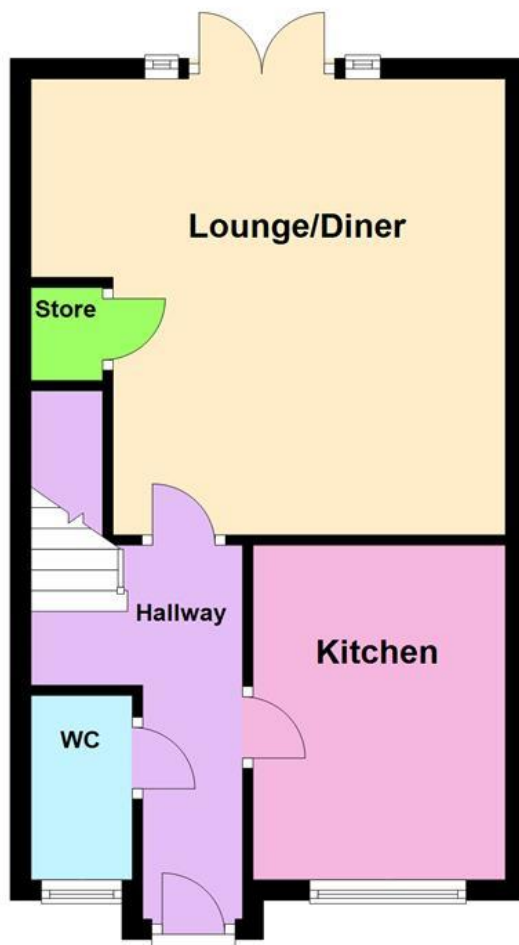

First Floor

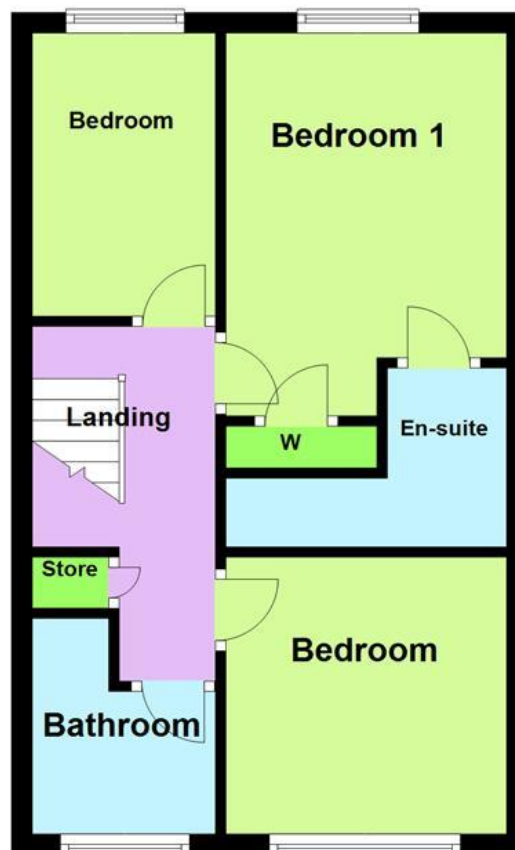

Energy Efficiency Rating

| Score | Energy rating | Current | Potential |
|-------|---------------|---------|-----------|
| 92+ | A | | 96 A |
| 81-91 | B | 83 B | |
| 69-80 | C | | |
| 55-68 | D | | |
| 39-54 | E | | |
| 21-38 | F | | |
| 1-20 | G | | |

Map Location

